

C:\2013\352\131-19416-00 - Ottawa Landfill Expansion\Drawings\DWG\DWG SITE PLAN APPROVAL APPLICATION\JULY 2015 RE131-19416-RS3.dwg Oct 07, 2015 - 2:47pm

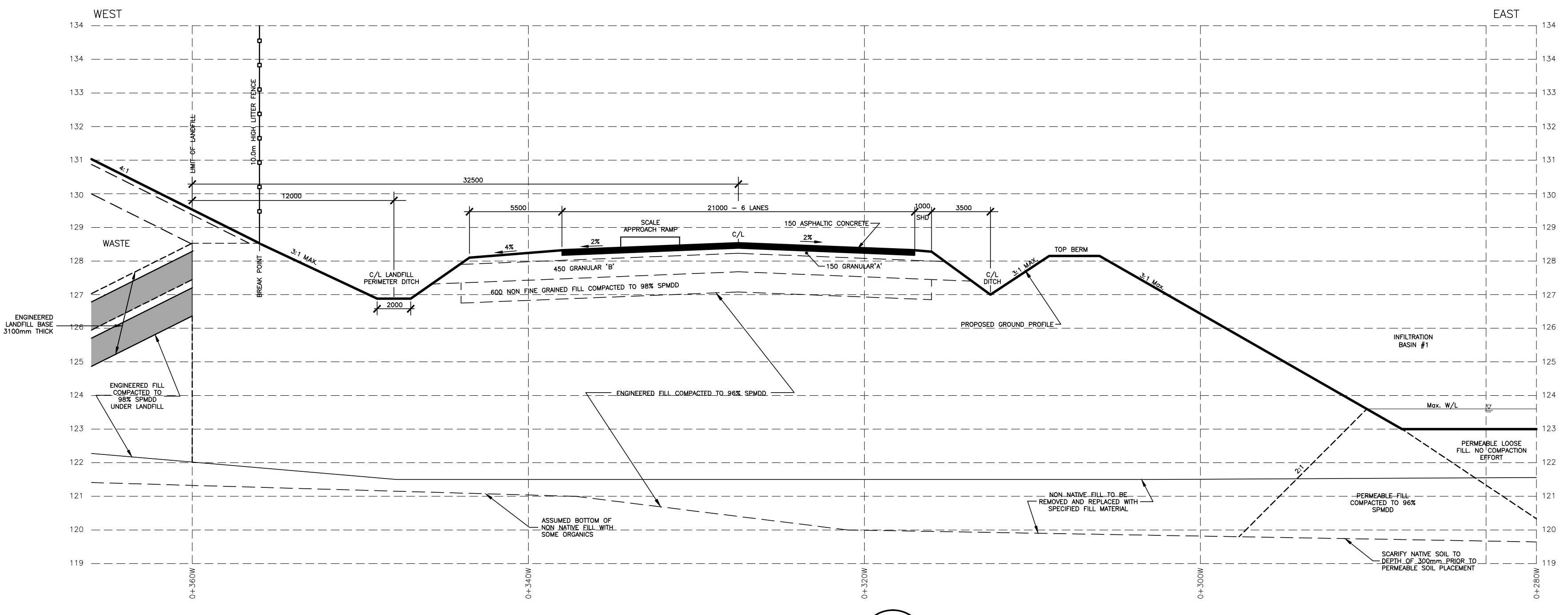

SECTION 7
 GRID 1+000N
 SCALES:
 1 : 200 HORIZONTAL
 1 : 100 VERTICAL
 DGN1

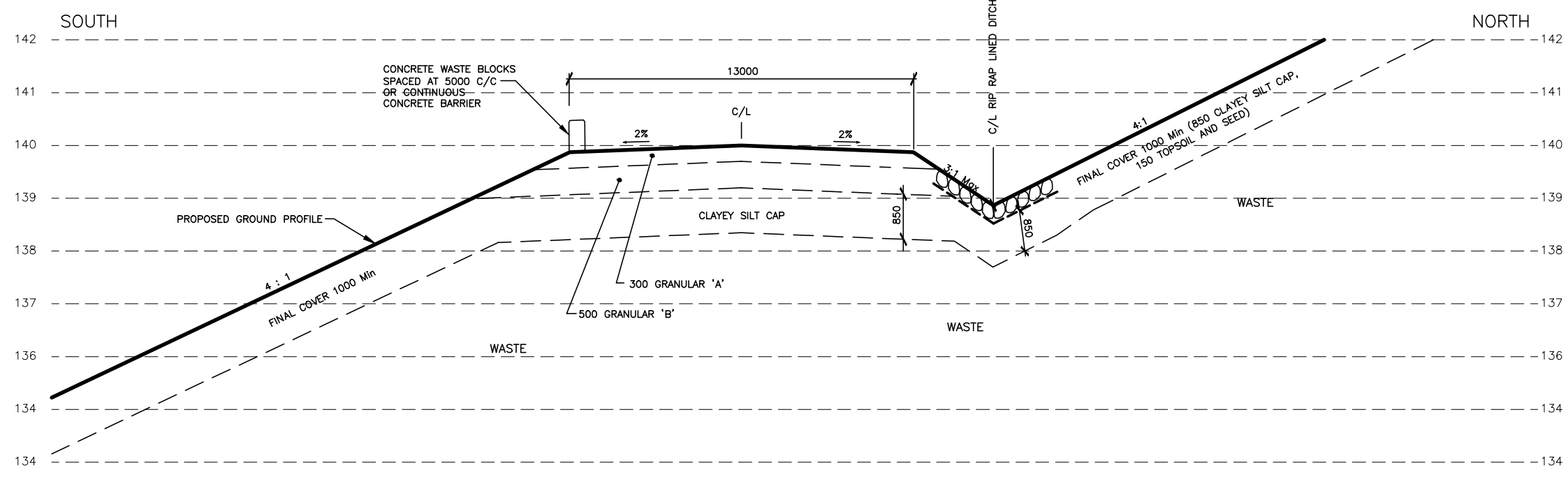

SECTION 8
 SCALES:
 1 : 200 HORIZONTAL
 1 : 100 VERTICAL
 DGN1

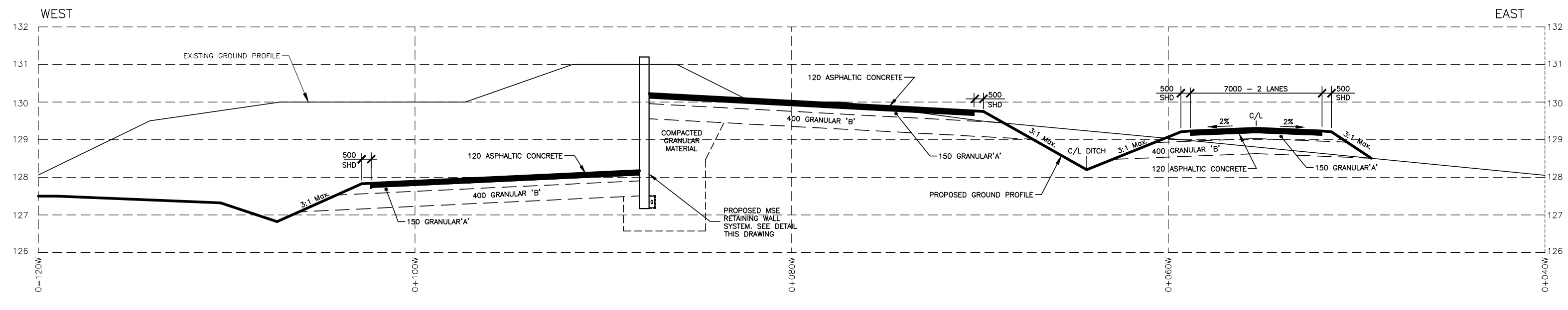

SECTION 9
 GRID 0+880N
 SCALES:
 1 : 200 HORIZONTAL
 1 : 100 VERTICAL
 DGN1

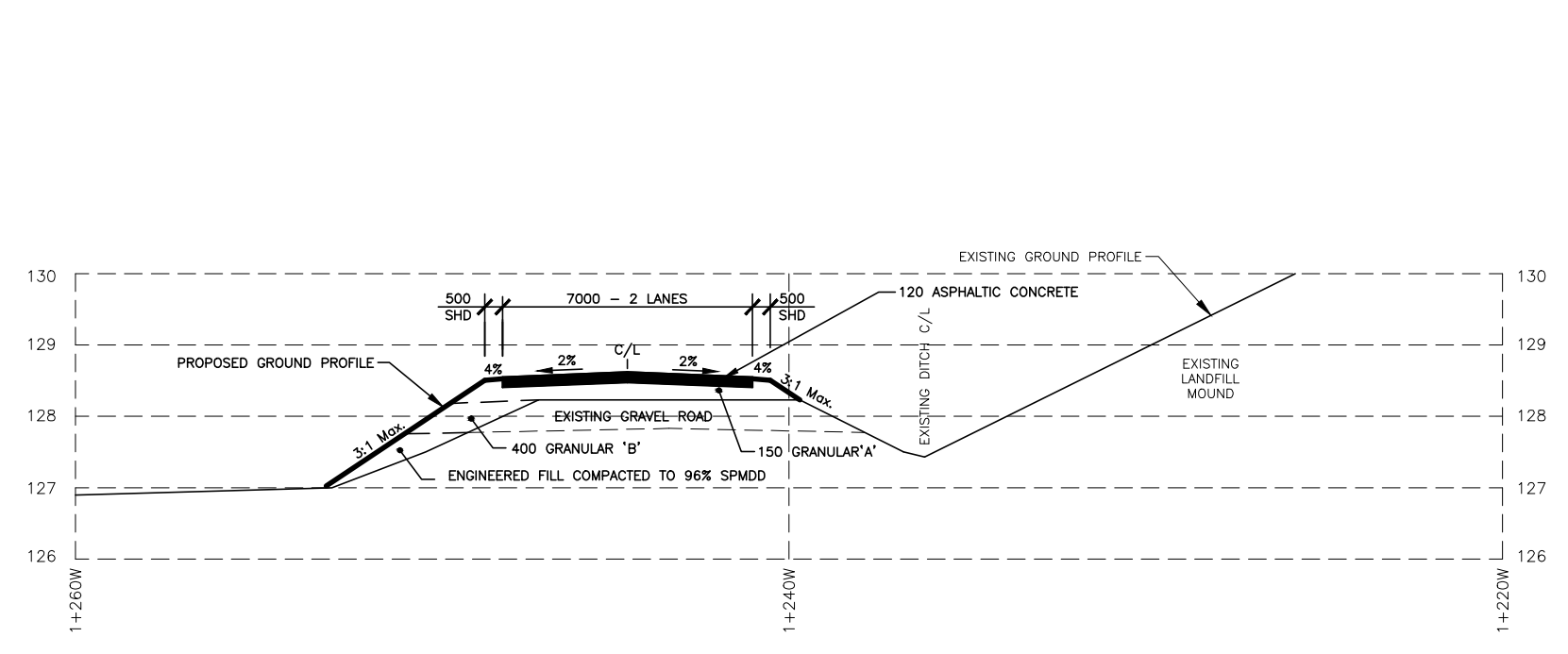

SECTION 10
 GRID 0+720N
 SCALES:
 1 : 200 HORIZONTAL
 1 : 100 VERTICAL
 DGN1

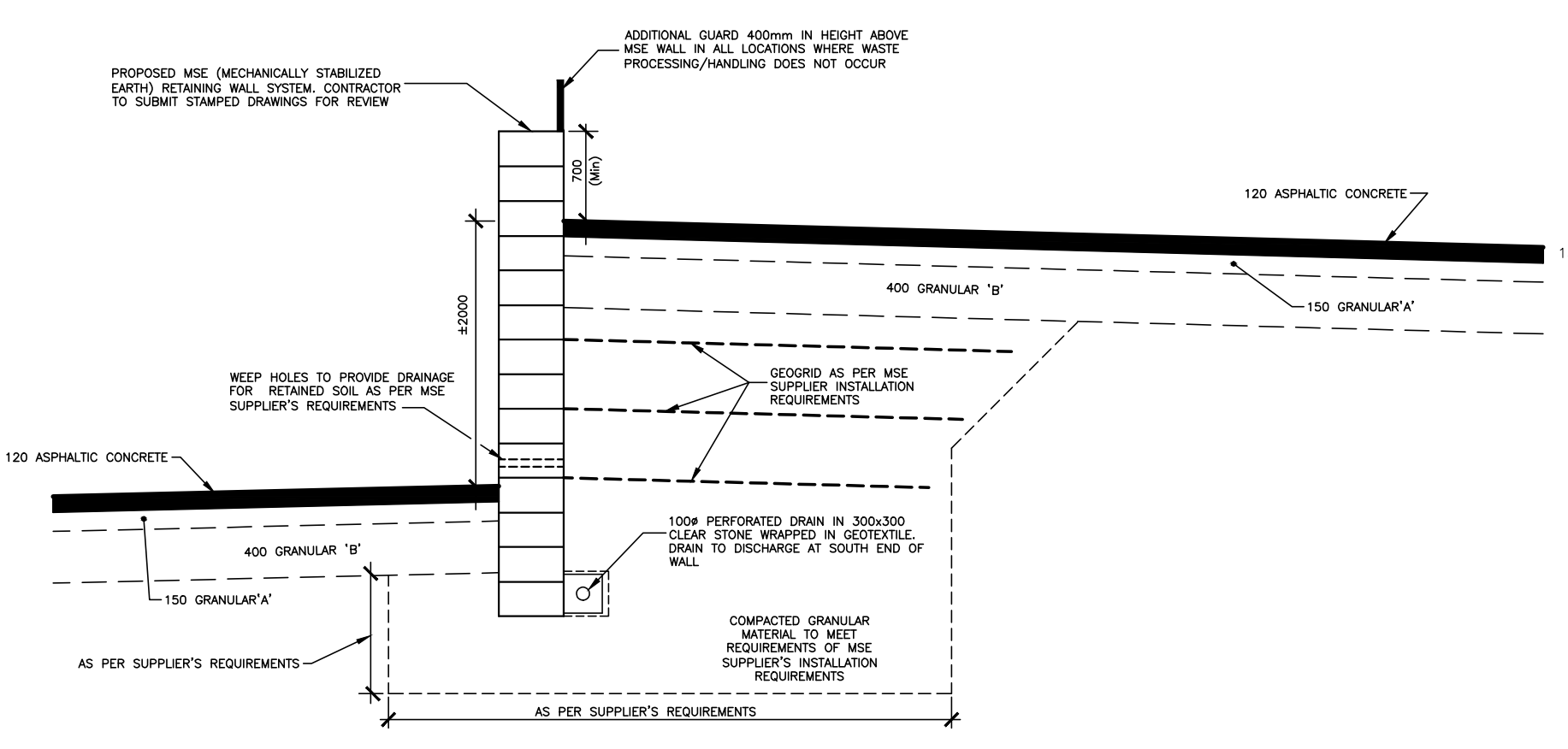

RETAINING WALL SYSTEM DETAIL
 SCALE: 1:50

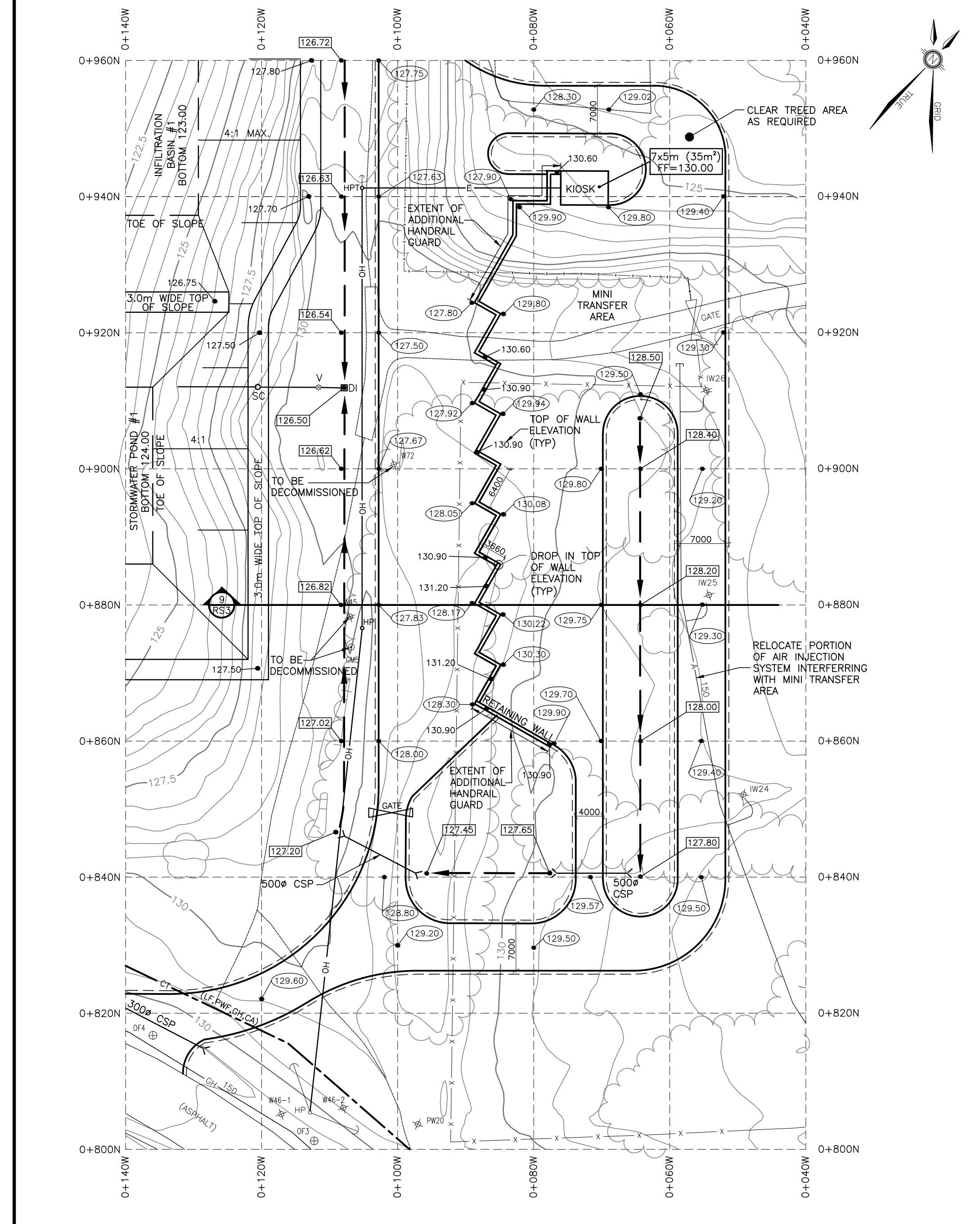

KIOSK - MINI TRANSFER AREA
 SCALE: 1:500

- NOTES:
1. WALL TO BE DESIGNED BY PROFESSIONAL ENGINEER LICENSED TO PRACTICE IN ONTARIO.
 2. WALL TO BE DESIGNED FOR TL-1 PERFORMANCE LEVEL BARRIER LOADS AS PER SECTION 5.8.8 OF THE CHBC.
 3. RETAINING WALL TO BE DESIGNED AS PER SECTION 6 OF THE CHBC.
 4. SEISMIC AND STABILITY DESIGN TO BE COMPLETED USING THE CRITERIA SPECIFIED IN DESIGN LETTER "PROPOSED RETAINING WALL, WEST CARLETON ENVIRONMENTAL CENTRE" DATED SEPTEMBER 4th, 2015 PREPARED BY ALSTON ASSOCIATES INC.

APPROVED REFUSED

THIS _____ DAY OF _____, 20__

DERRICK MOODIE, MANAGER
 DEVELOPMENT REVIEW, RURAL SERVICES

DATE	DESCRIPTION

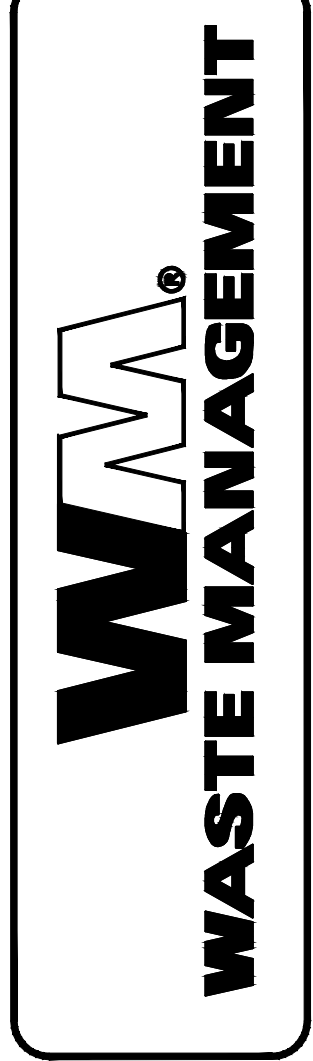
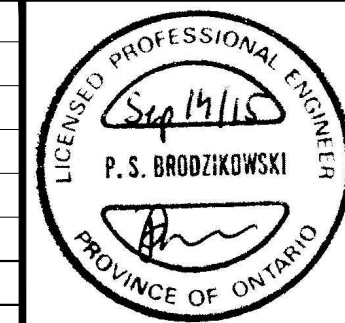

LANDFILL ROAD SECTIONS
 WEST CARLETON ENVIRONMENTAL CENTRE

WASTE MANAGEMENT OF CANADA CORPORATION
 131-19416-00 - RS-3
 DRAWING NO.

DRAWING
 RS-3

CITY OF OTTAWA FILE # D07-12-15-0085